



TPMS Diagnostic Tool

## O-Genius

### User's Manual

ID COPY Patent Number

1.8031064C3

2.I522602

3.CN101881699B

4.JP5463568



### Orange Electronic Co., Ltd.

(Headquarter) 5F, NO.29, Keya Rd. Central  
Taiwan Science Park, Taichung 42881, Taiwan  
service@orange-electronic.com

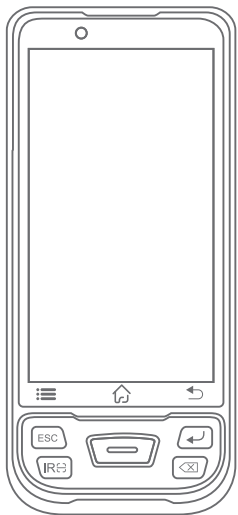

O-Genius

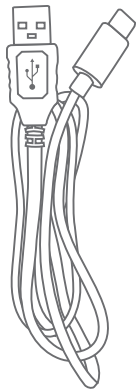

Power Cable

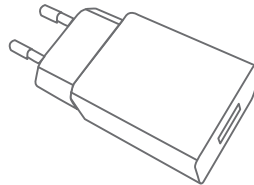

Power Adapter

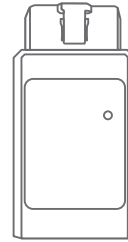

OBD II Dongle  
(Refer as OBD below )

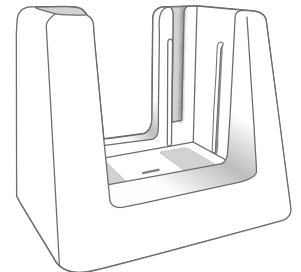

Charge stand

## Specifications

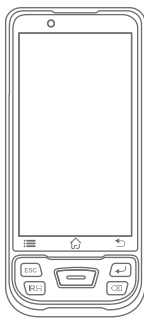

Operating System	Android 9.0
Processor	Octa-core processor (2.0 GHz)
Memory	3GB RAM & 32GB ROM
Display	5" High Resolution IPS 1280x720
Camera	13 MP
Connectivity	Wi-Fi; Bluetooth 5.0; Type C (USB 2.0)
Power	3.8V lithium-polymer battery ; 7500 mAh
Operating Temperature	-10°C to 50°C (4°F to 122°F)
Storage Temperature	-20°C to 70°C (-4°F to 158°F)
Weight	465g



Operating Voltage	DC 12V
Operating Current	<50mA
Bluetooth	5.0
Operating Temperature	- 30 °C to 75°C (-22°F to 167°F)
Storage Temperature	- 40 °C to 85°C (-40°F to 185°F)

## 1 Connect to WiFi

1. Select language
2. Please confirm "Privacy Policy"
3. Connect to WiFi
4. Click "First time login"

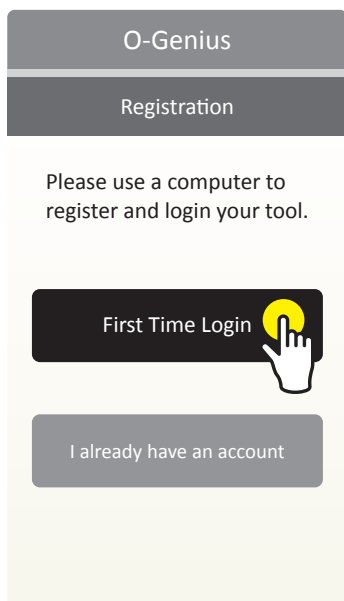

## 2 Search or enter the OSOM URL

Find a computer with internet access, and enter the following address: osom.orange-electronic.com



## 3 Click "Register"

Click the register button on the OSOM website home page.

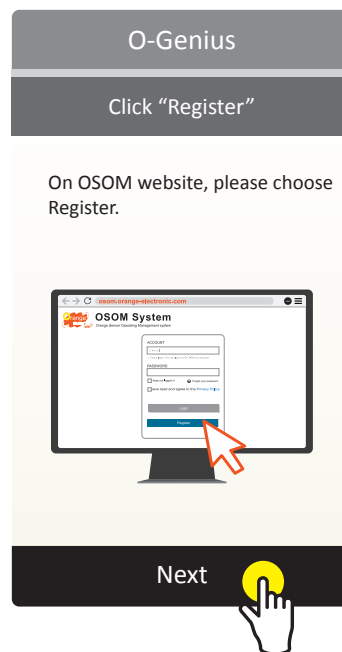

## 4 Enter registration information

Enter the required information on the signup pages.

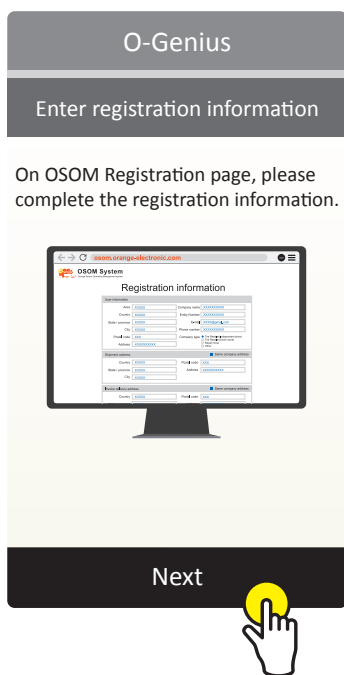

## 5 Scan login

Please use TOOL to click the scan button and scan a QR Code on your computer screen to log in

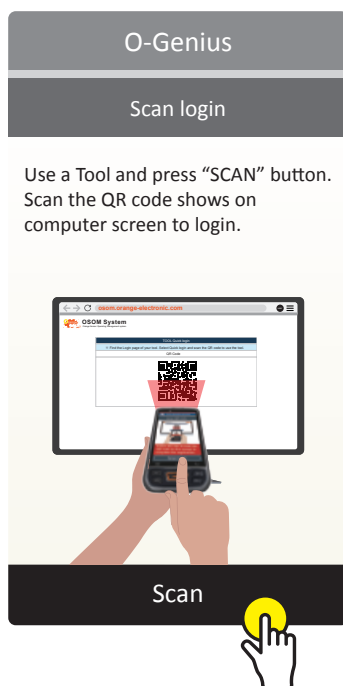

## 6 Completed

After registration, the account will be bound to the tool serial number. If you forget your account, please contact customer service for assistance.

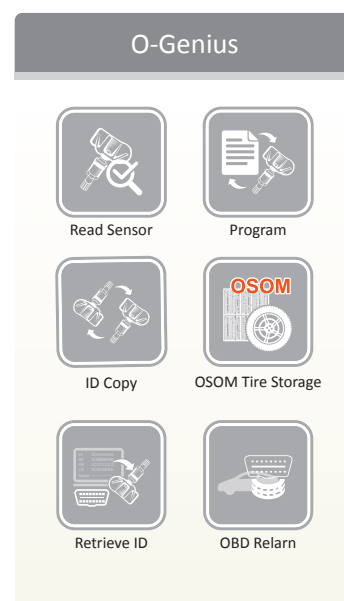

## 1 Select "Read Sensor"



## 2 Select "Vehicle Selection"

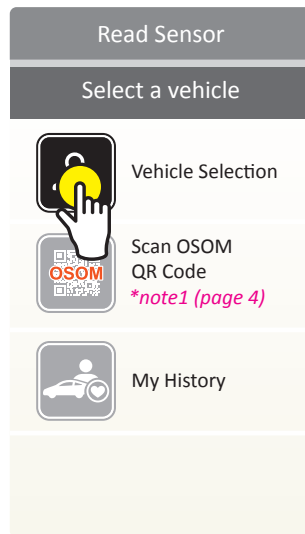

## 3 Select Make, Model, Year

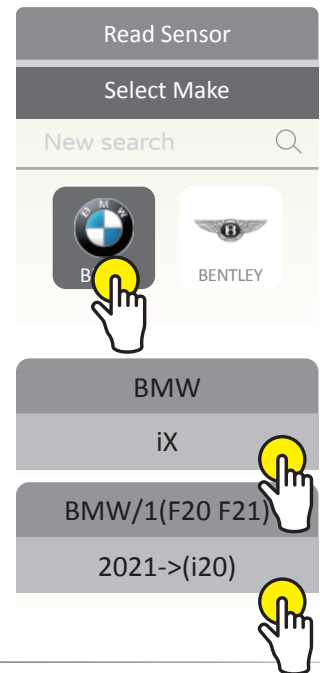

## 4 Select "Read Sensor"

Select "Read Sensor", to check the sensor.

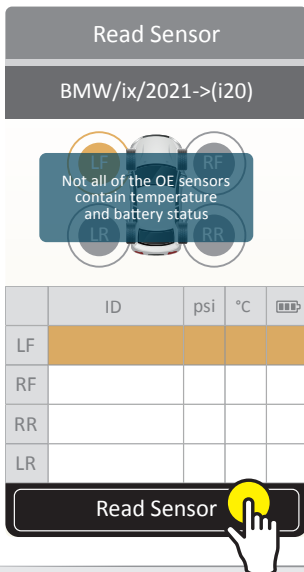

## 5 Completed

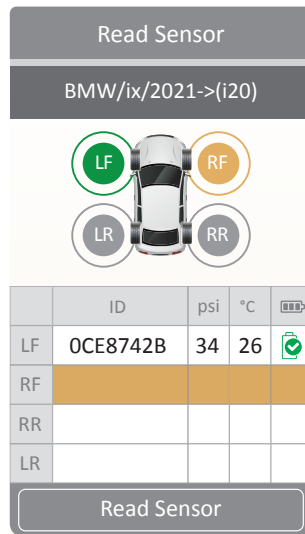

### Note 1:\* Scan OSOM QR Code

1. Select "OSOM-QR-Code scannen"
2. Link to OSOM System <https://osom.orange-electronic.com/> and select "Relearn Procedure" to get the QR Code.

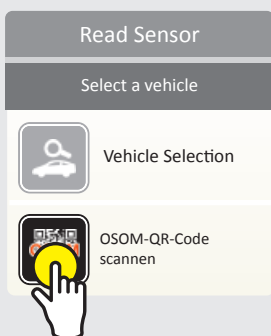

3. Scan the QR Code on the OSOM website

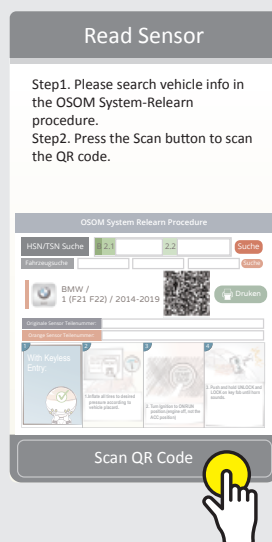

4. Obtain the vehicle MMY

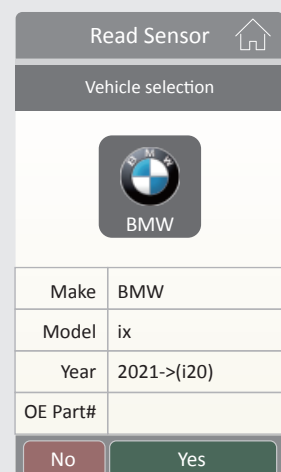

## 1 Select "Program"

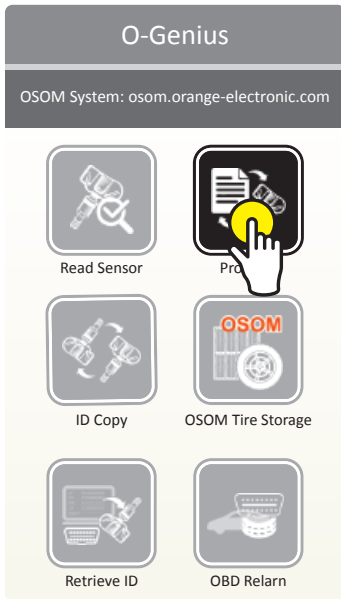

## 2 Select "Vehicle Selection"

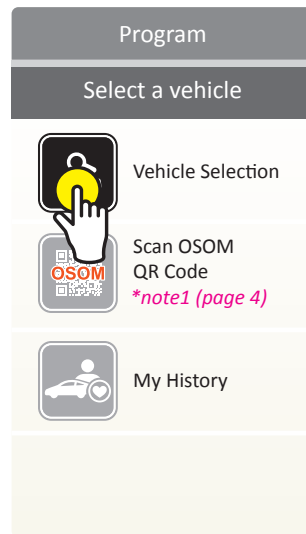

## 3 Select Make, Model, Year

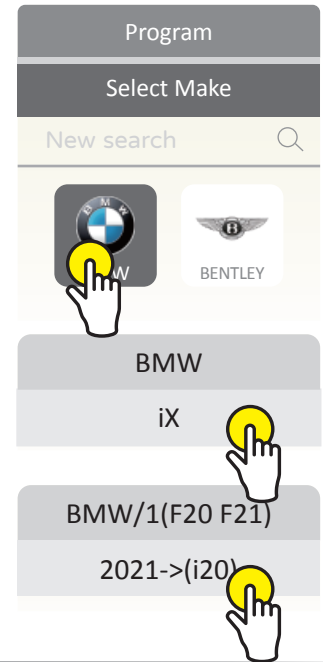

## 4 Select of the sensor quantity

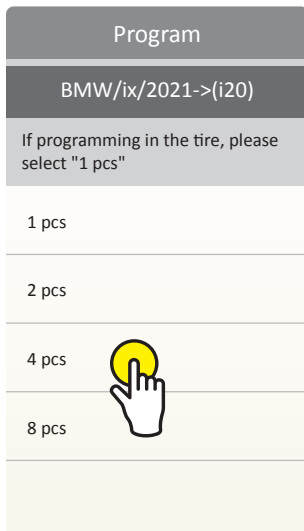

## 5 Select enter ID method

1. Trigger: Standard method
2. Scan QR Code: More Accurate

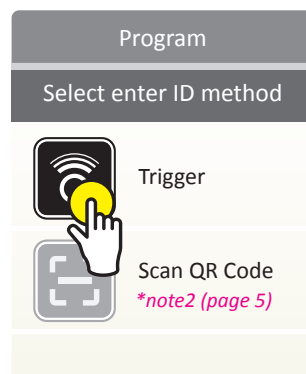

## 6 Select "Program"

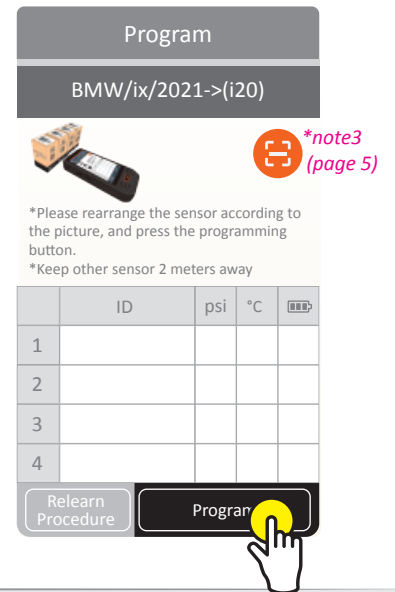

## 7 Completed

Click "Send me" can keep the programming data(ID number, tire pressure, MMY, Time) to your mail.

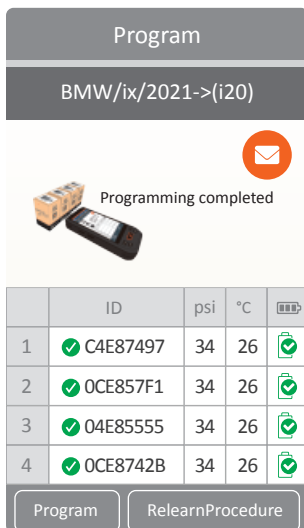

### Note2\* Scan QR Code Function

"Scan QR Code" can be more accurate than "Trigger"

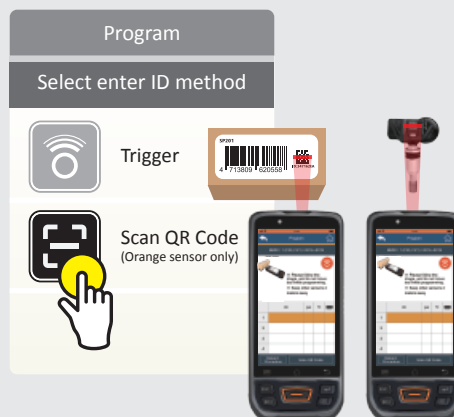

### Note3\* Switch to ID key-in method

Click this icon can switch to ID key-in method

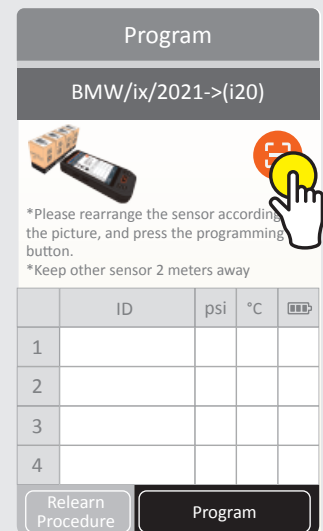

# ID-Copy- Single program

## 1 Select "ID-Copy"

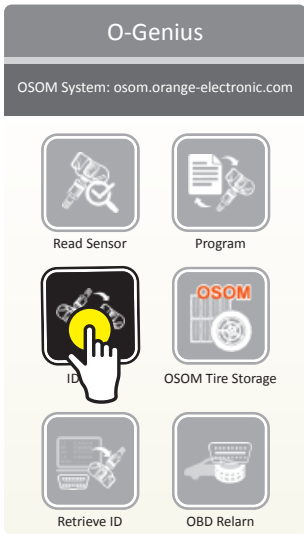

## 2 Select a vehicle

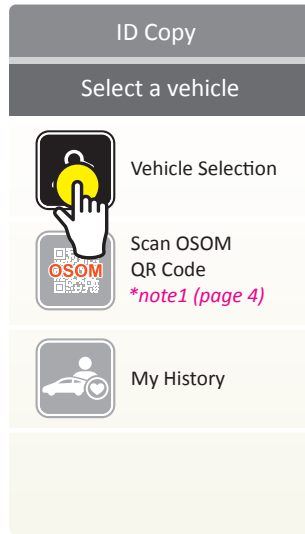

## 3 Select Make, Model, Year

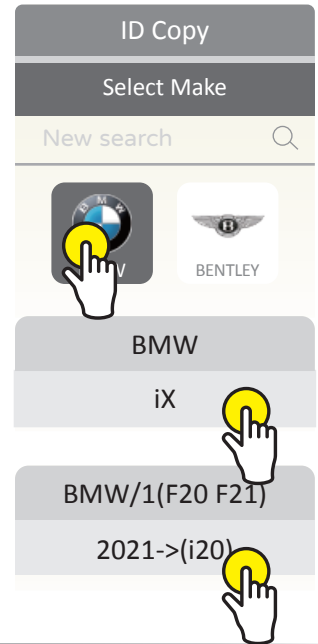

## 4 Select "Single Program"

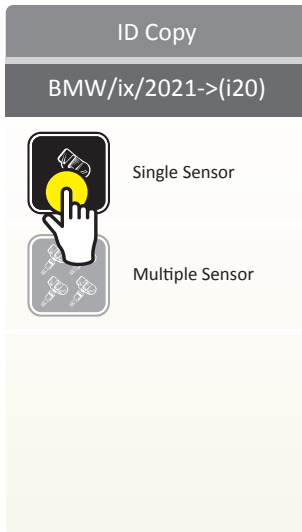

## 5 Select "Read Sensor"

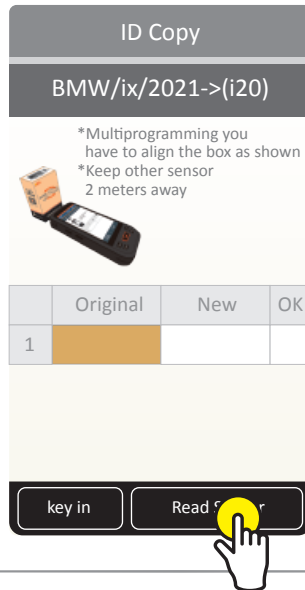

## 6 Click "ID Copy"

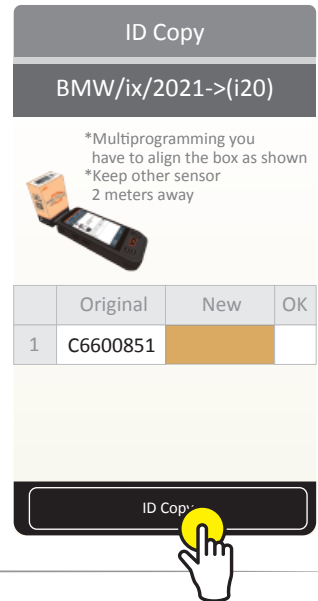

## 7 Completed

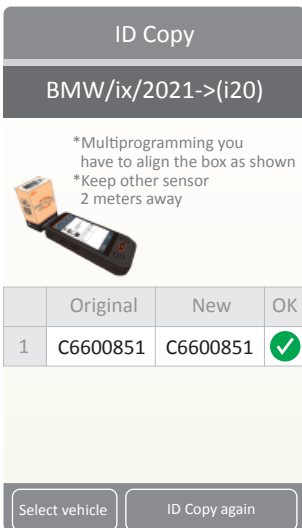

# ID-Copy- multi program

## 1 Select "ID-Copy"

Select "ID-Copy" and then choose "Vehicle Selection"

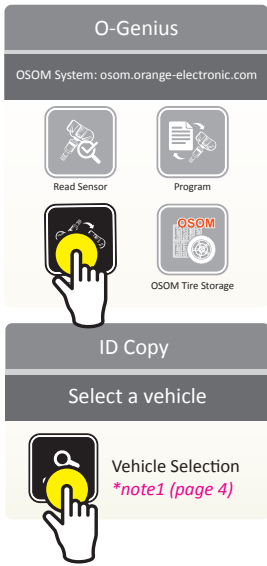

## 2 Select Make, Model, Year

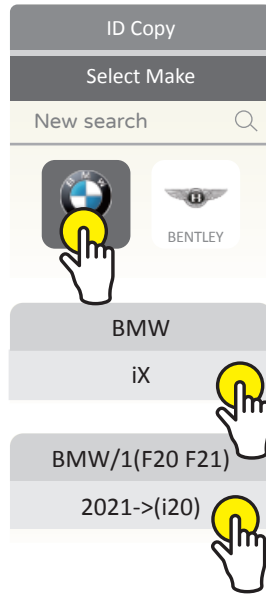

## 3 Select "Multi Program"

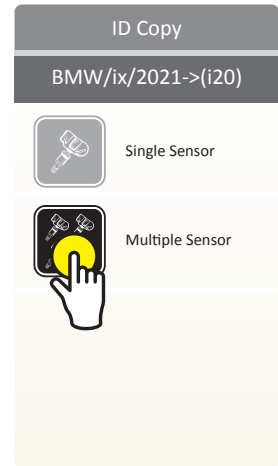

## 4 Read sensor ID

Start at the front left tire and read the sensor IDs clockwise. (LF, RF, RR, LR)

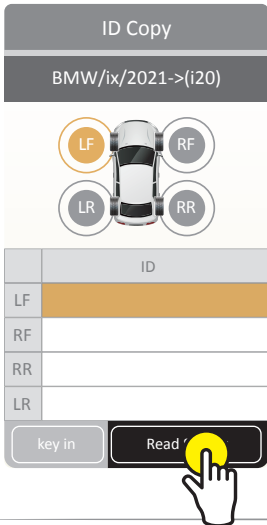

## 5 Select "Next"

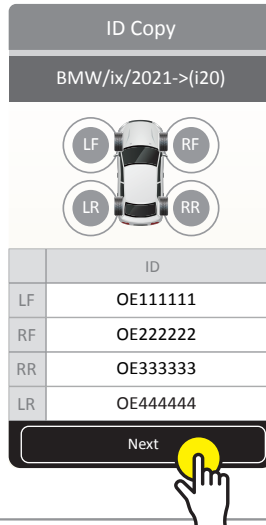

## 6 Click "I understand"

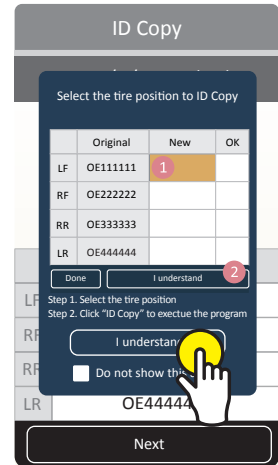

## 7 Select "ID Copy"

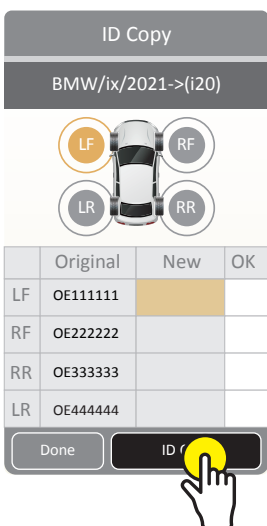

## 8 Select next tire position and click "ID Copy"

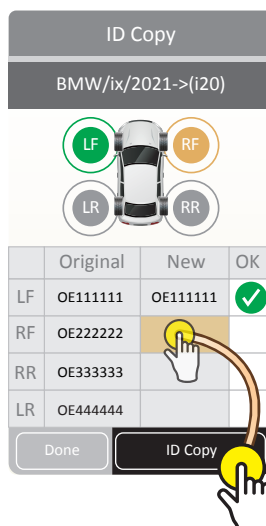

## 9 Completed

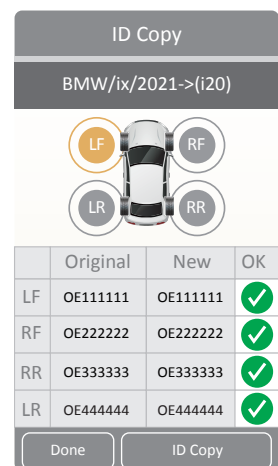

## 1 Select "Retrieve ID"

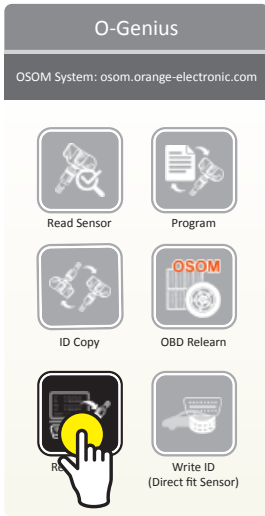

## 2 Select "Vehicle Selection"

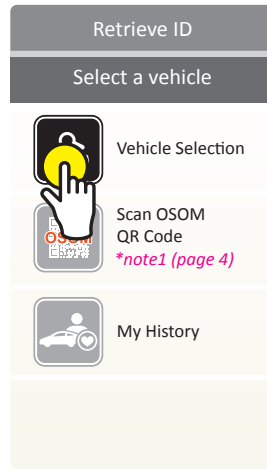

## 3 Connect to OBD

1. Turn ignition to ON, engine off, then plug in OBD
2. System will detect OBD device. Please click "Orange\_OBDXX"

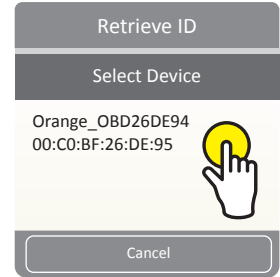
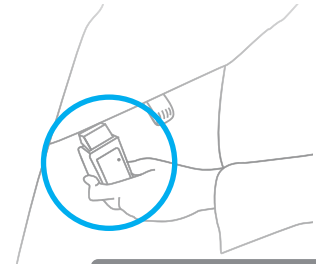

## 4 Select Make, Model, Year

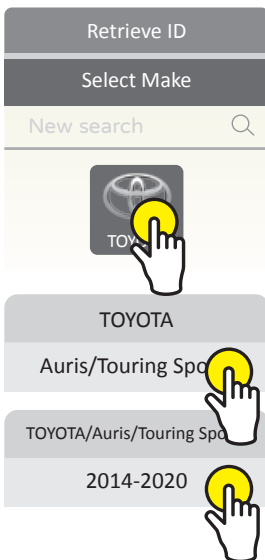

## 5 OBD reads Original Sensor ID

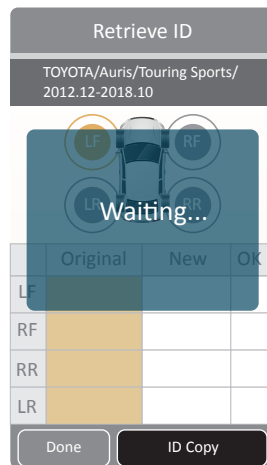

## 6 Remove OBD device



## 7 Select "ID Copy"

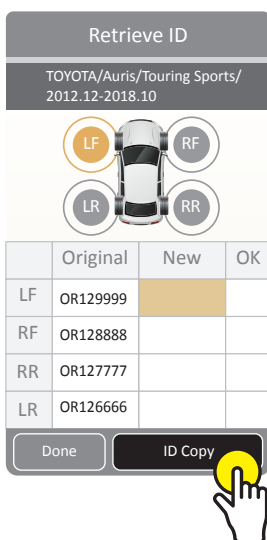

## 8 Select next tire position and click "ID Copy"

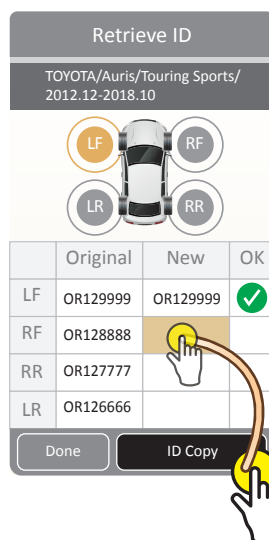

## 9 Completed

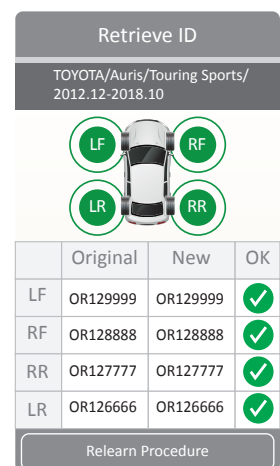



## 1 Select "OBDelearn"

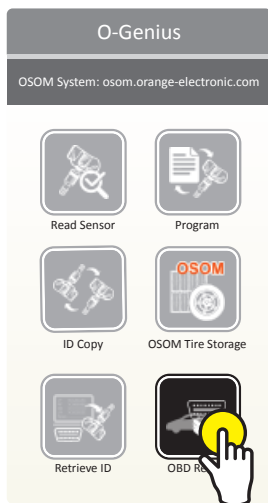

## 2 Select "Vehicle Selection"

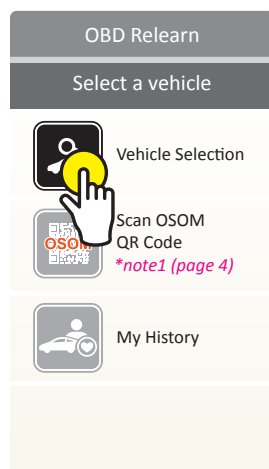

## 3 Select Make, Model, Year

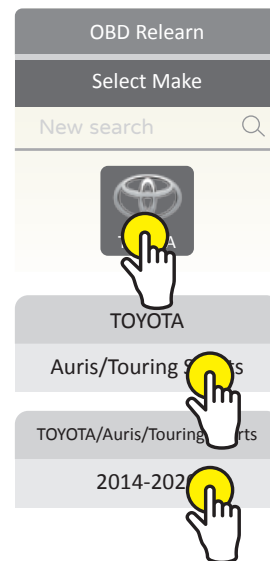

## 4 Select "OBDelearn"

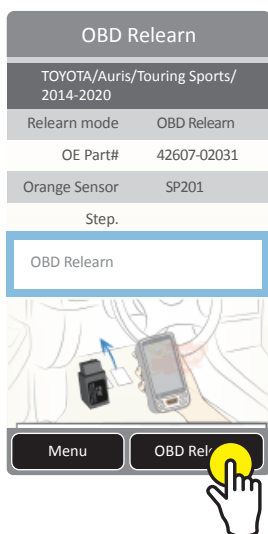

## 5 Select the Number of Tires

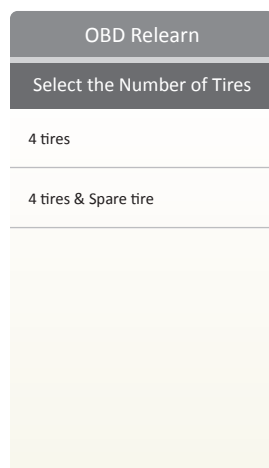

## 6 Select "Read Sensor"



## 7 Select "Start Transfer"

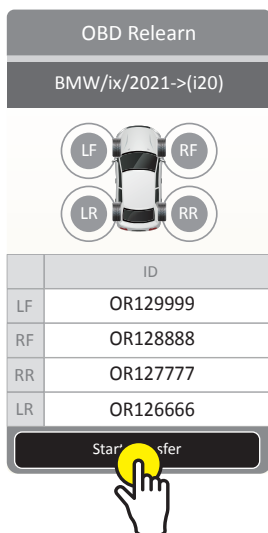

## 8 Connect to OBD

1. Turn ignition to ON, engine off, then plug in OBD
2. System will detect OBD device. and click it.

*\*Sensor ID and Tire position data are transferred to OBD separately.*

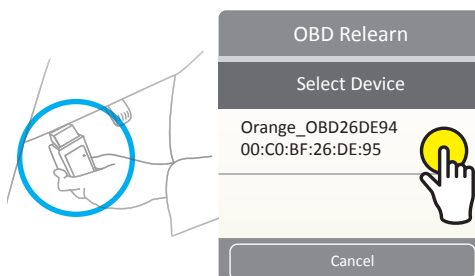

## 9 Completed



# Relearn Procedure

## 1 Select "Relearn Procedure"

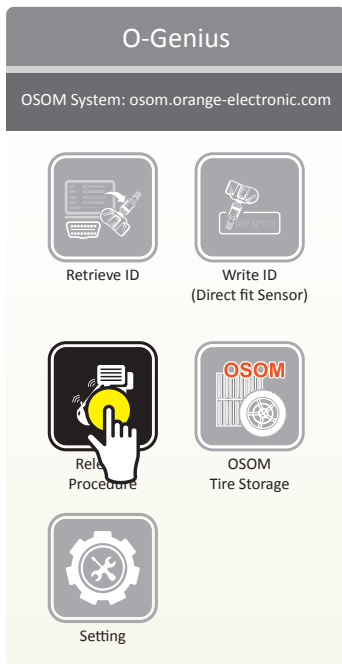

## 2 Select "Vehicle Selection"

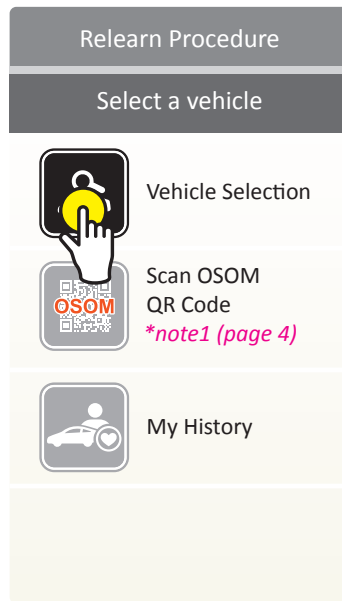

## 3 Select Make, Model, Year

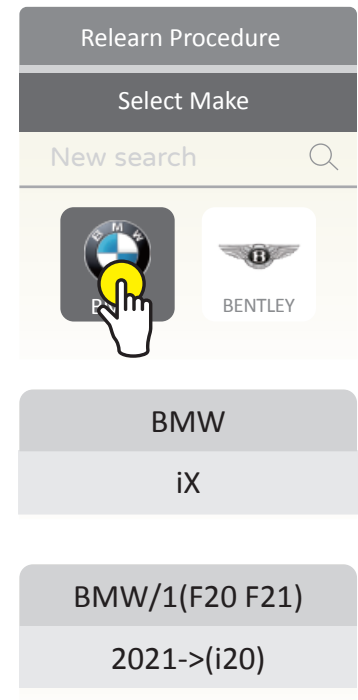

## 4 Completed

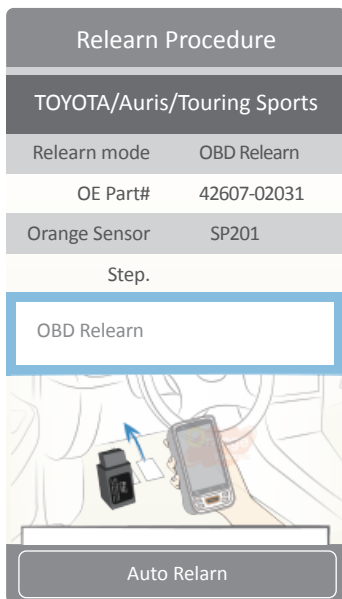

# OSOM Tire Storage- Read Sensor

## 1 Select "OSOM Tire Storage"



## 2 Select "Reservation List"

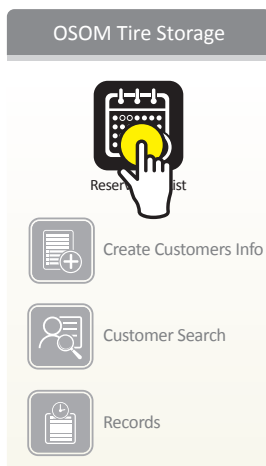

## 3 Select "Next"

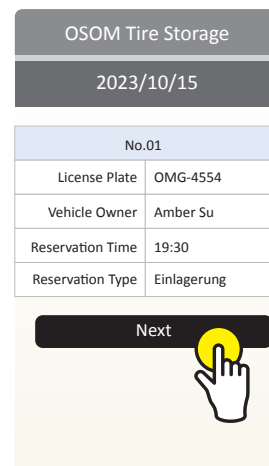

## 4 Check reservation list Select "Next, tire information".

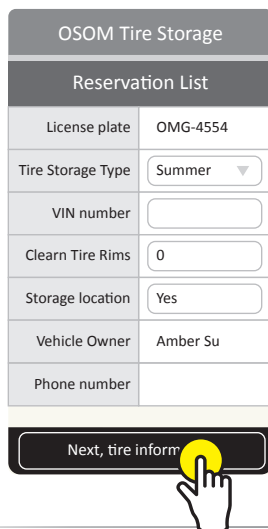

## 5 Check tire information Select "rim info".

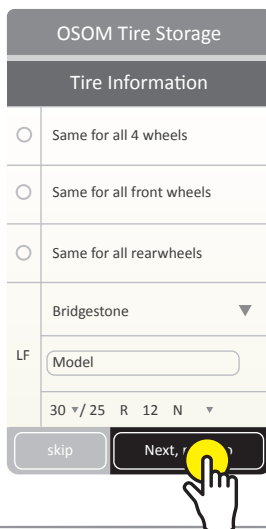

## 6 Check Rim info Select "Next, tire depth"

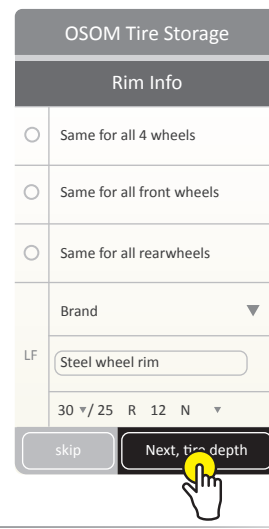

## 7 Enter tire depth Select "Next, tire Photo".

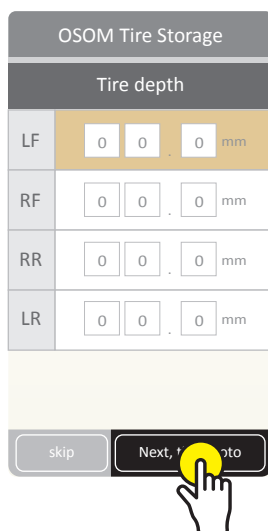

## 8 Take a photo of tire Select "Next, DOT serial number".

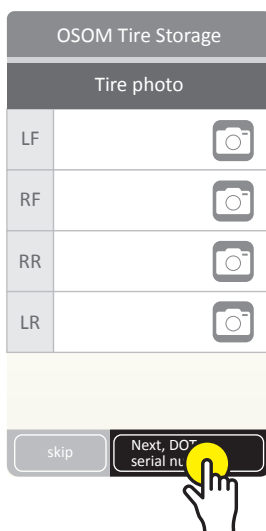

## 9 Enter DOT Serial Number Select "Next, tire pressure information".

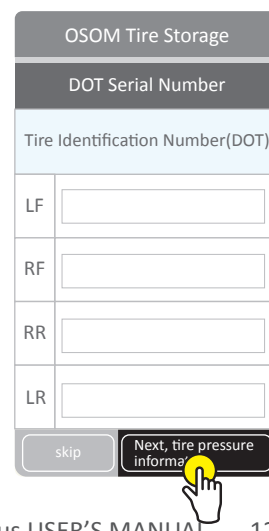

# OSOM Tire Storage- Read Sensor

## 10 Select a vehicle

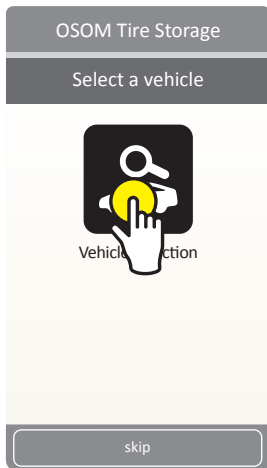

## 11 Select MMY

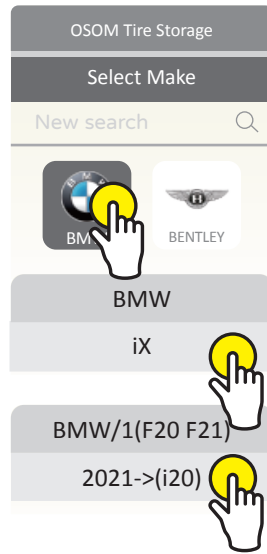

## 12 Confirm the MMY

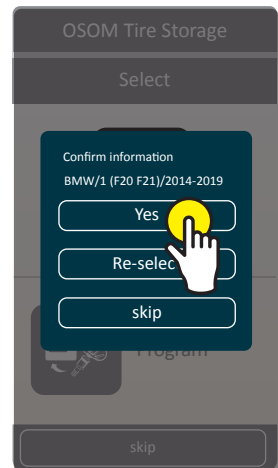

## 13 Select "Read sensor"

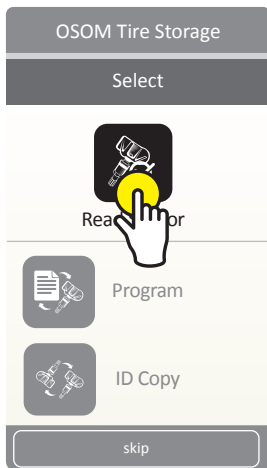

## 14 Select "Read sensor"

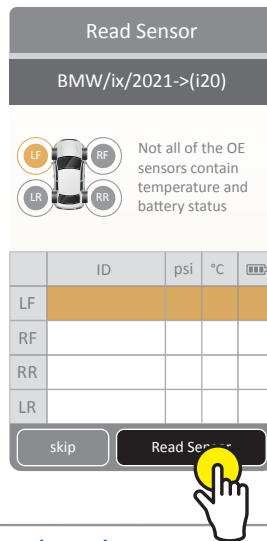

## 15 Select "Next"

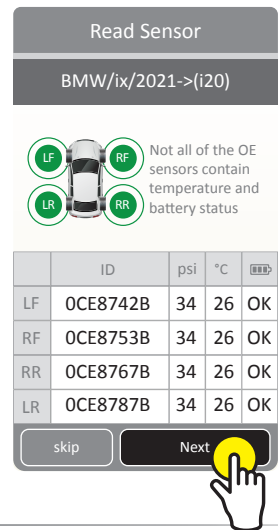

## 16 Select "Save"

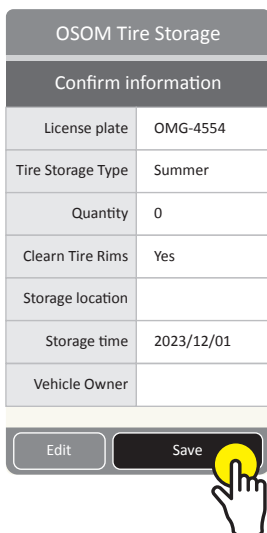

## 17 Completed

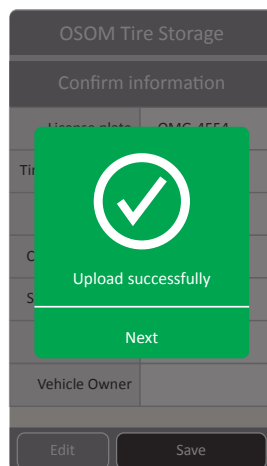

# OSOM Tire Storage- Program

## 1 Select "OSOM Tire Storage"

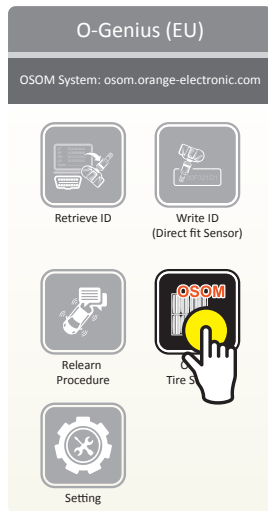

## 2 Select "Reservation List"

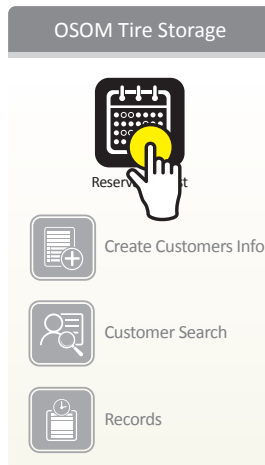

## 3 Select "Next"

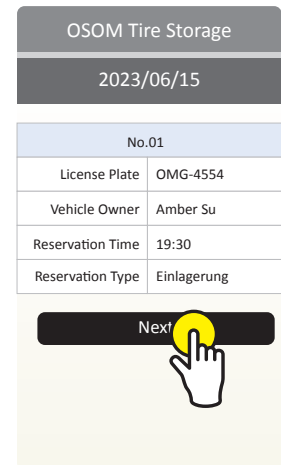

## 4 Check reservation list Select "Next, tire information".

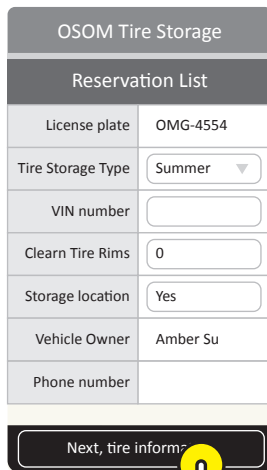

## 5 Check tire information Select "rim info".

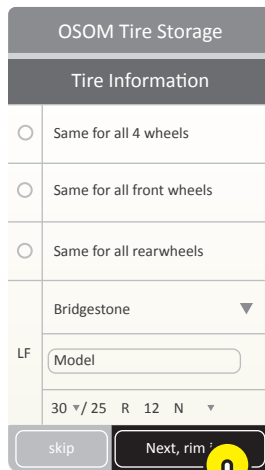

## 6 Check Rim info Select "Next, tire depth".

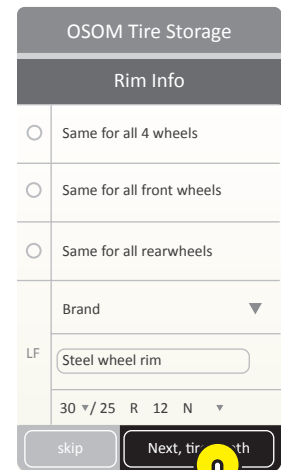

## 7 Enter tire depth Select "Next, tire Photo".

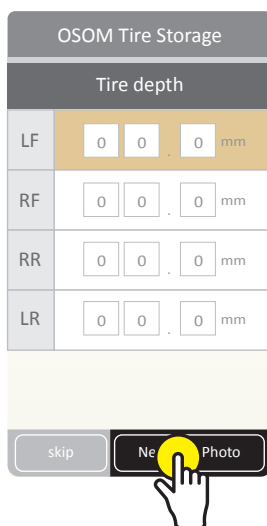

## 8 Take a photo of tire Select "Next, DOT serial number".

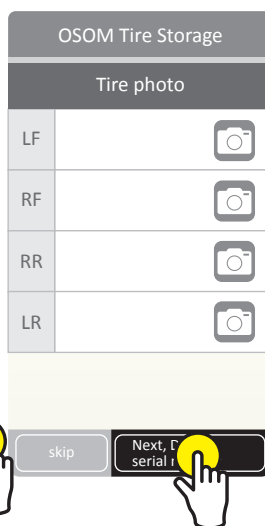

## 9 Enter DOT Serial Number Select "Next, tire pressure information".

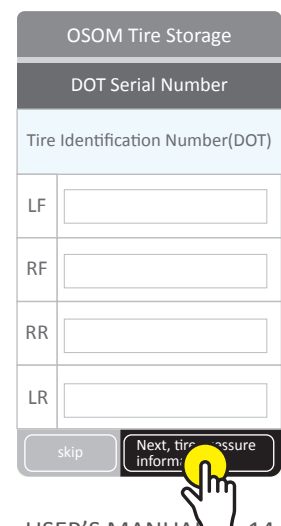

# OSOM Tire Storage- Program

## 10 Select a vehicle

Select "Vehicle Selection"

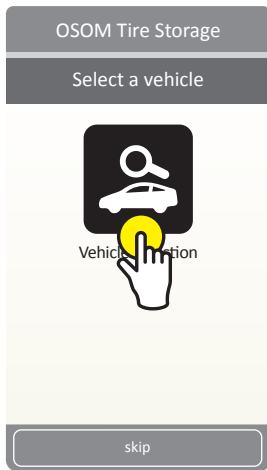

## 11 Select MMY

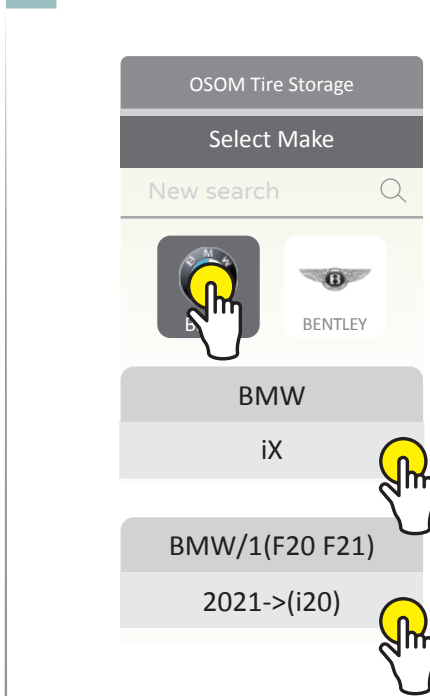

## 12 Confirm the MMY

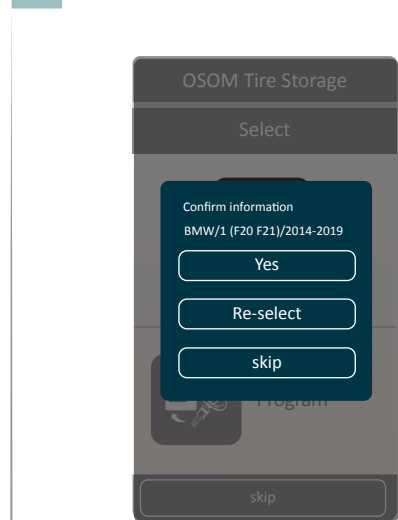

## 13 Select "Read sensor"

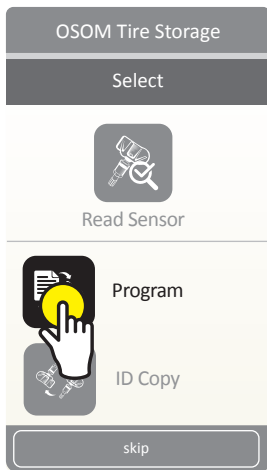

## 14 Select "Read sensor"

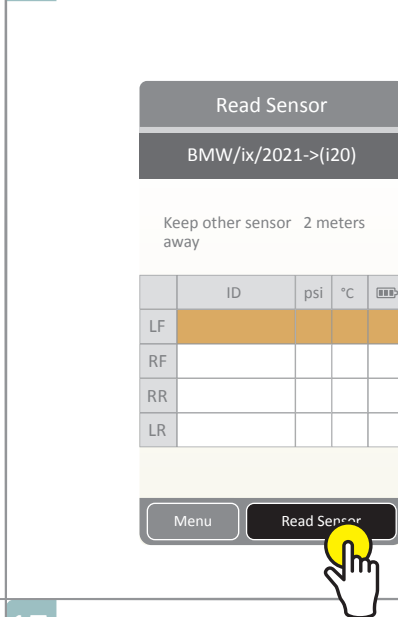

## 15 Select "Program"

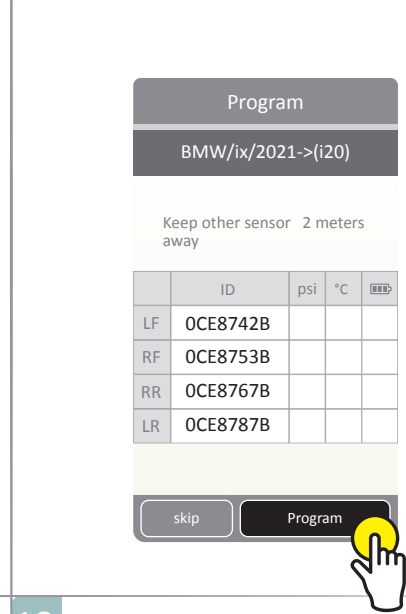

## 16 Select "Next"

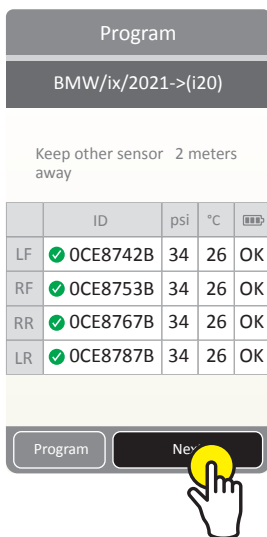

## 17 Select "Save"

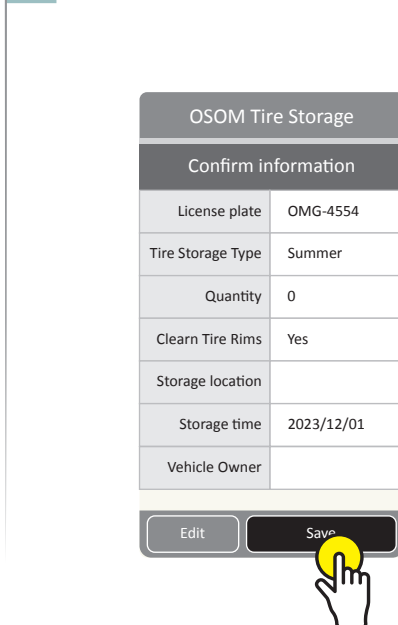

## 18 Completed

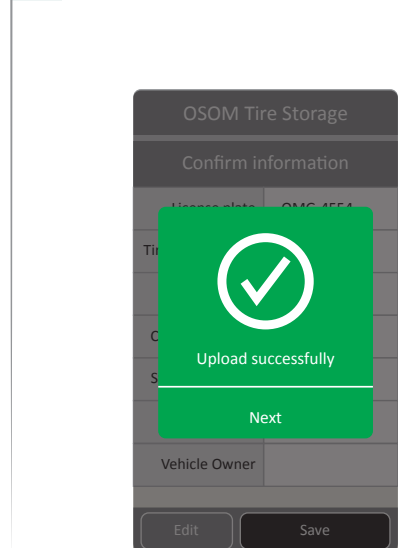

## 1 Select "OSOM Tire Storage"

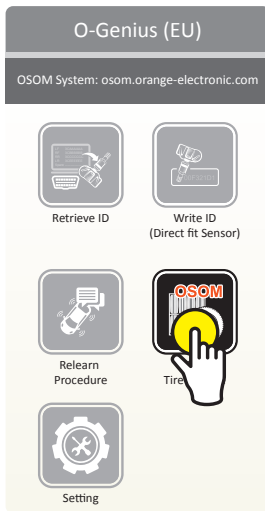

## 2 Select "Reservation List"

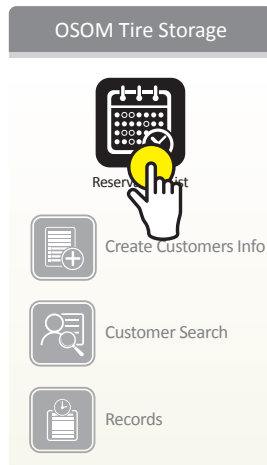

## 3 Select "Next"

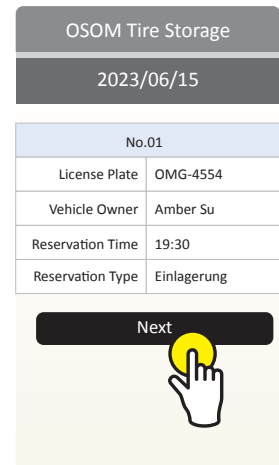

## 4 Check reservation list Select "Next, tire information".

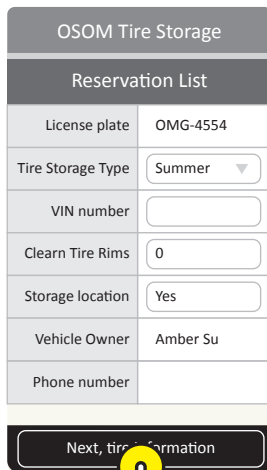

## 5 Check tire information Select "rim info".

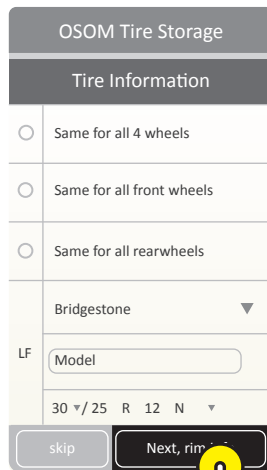

## 6 Check Rim info Select "Next, tire depth".

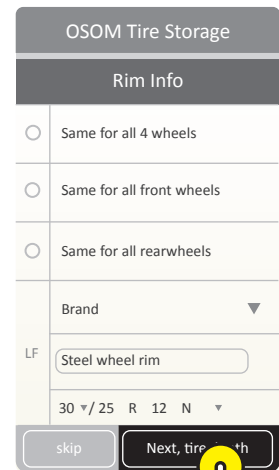

## 7 Enter tire depth Select "Next, tire photo".

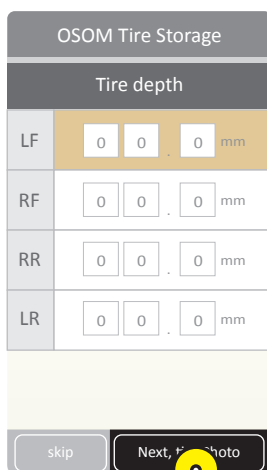

## 8 Take a photo of tire Select "Next, DOT serial number".

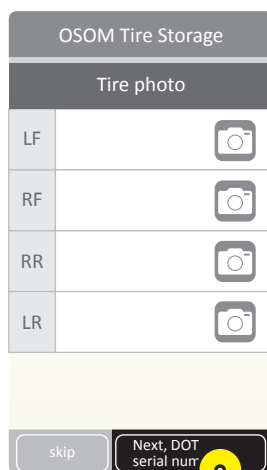

## 9 Enter DOT Serial Number Select "Next, tire pressure information".

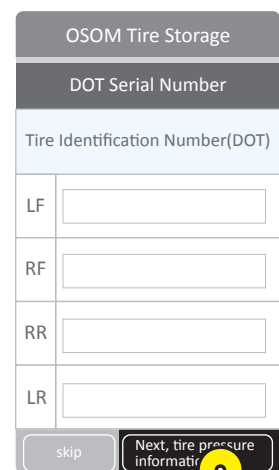

## 10 Select a vehicle

Select "Vehicle Selection"

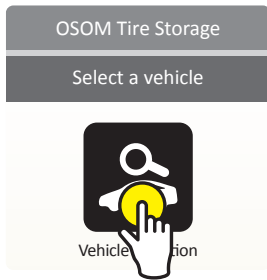

## 11 Select MMY

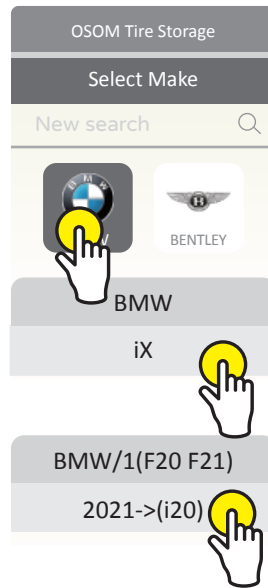

## 12 Confirm the MMY

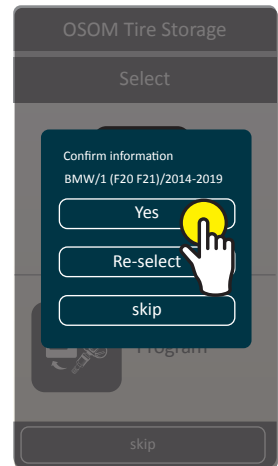

## 13 Select "ID Copy"

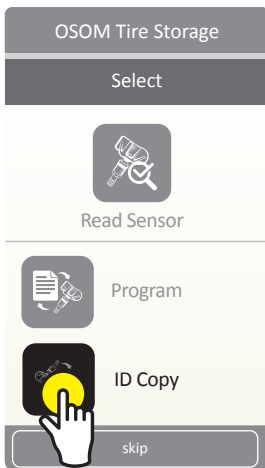

## 14 Select "Read sensor"

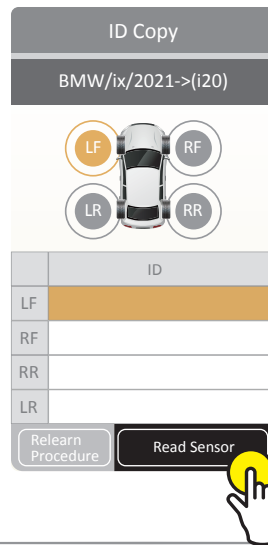

## 15 Select "Next"

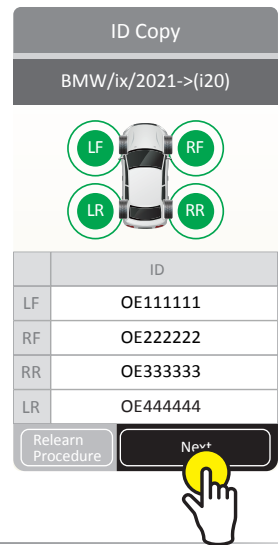

## 16 Select "ID Copy"

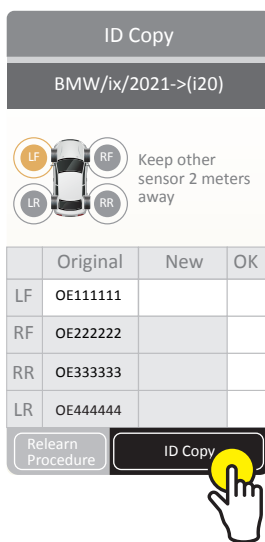

## 17 Select next tire position and click "ID Copy"

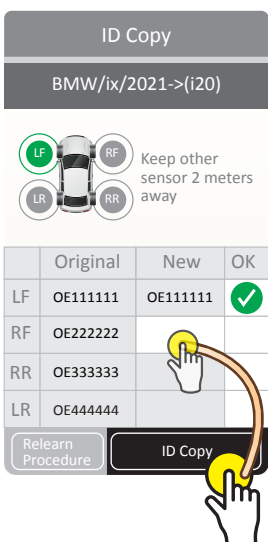

## 18 Select "Next"

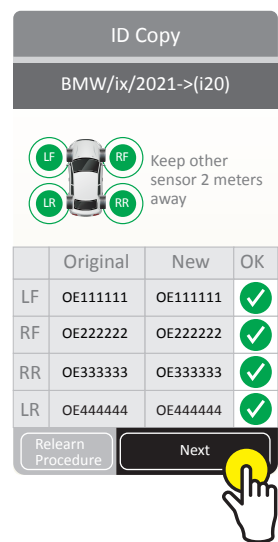



## 19 Select "Save"

OSOM Tire Storage	
Confirm information	
License plate	OMG-4554
Tire Storage Type	Summer
Quantity	0
Clean Tire Rims	Yes
Storage location	
Storage time	2023/12/01
Vehicle Owner	



## 20 Completed

OSOM Tire Storage	
Confirm information	
License plate	OMG-4554
Tire Storage Type	Summer
Quantity	0
Clean Tire Rims	Yes
Storage location	
Storage time	2023/12/01
Vehicle Owner	

  
Upload successfully

## 1 How many sensors can be programmed simultaneously?

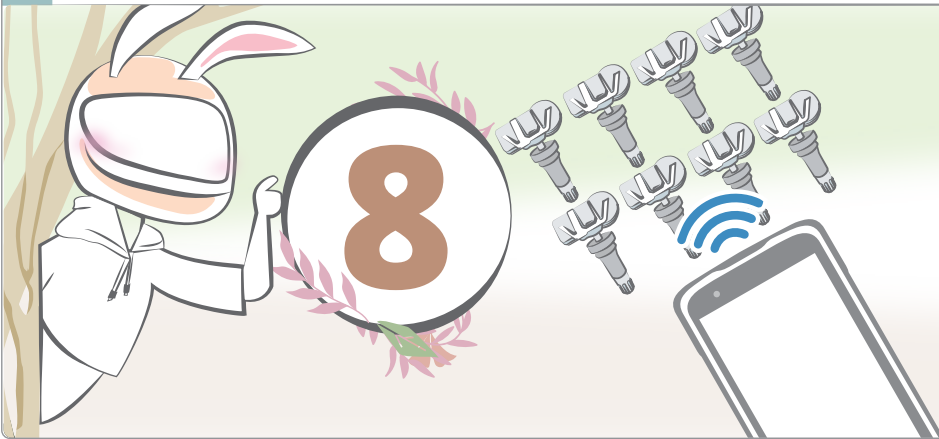

O-Genius can program up to 8 sensors at the same time.

## 2 (Read /Program) Read /Program failure when sensor mounted inside the tire.



Place the top of O-Genius at the tire position where the valve is for programming. (As the graphic on the left)  
**DO NOT** move O-Genius tool while programming.

## 3 Program failure. Sensor is not mounted inside the tire.

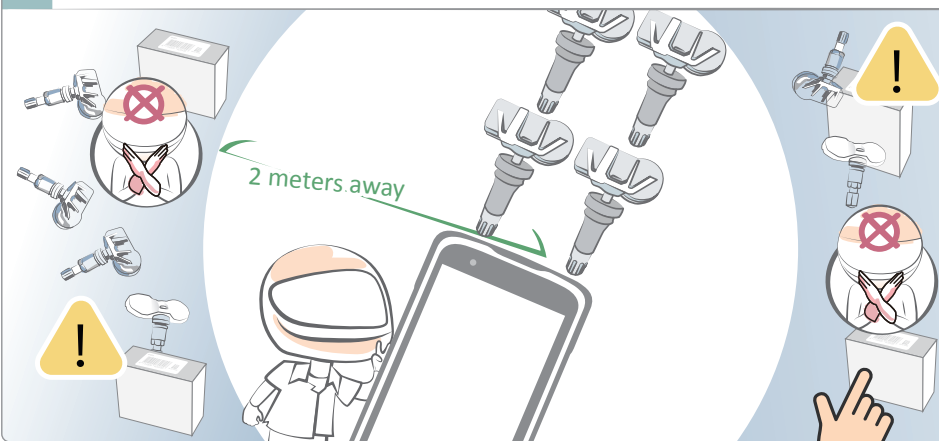

Please make sure other sensors are at least 2 meters away, and **DO NOT** move O-Genius while programming.

## 4 (ID Copy) ID Copy failure

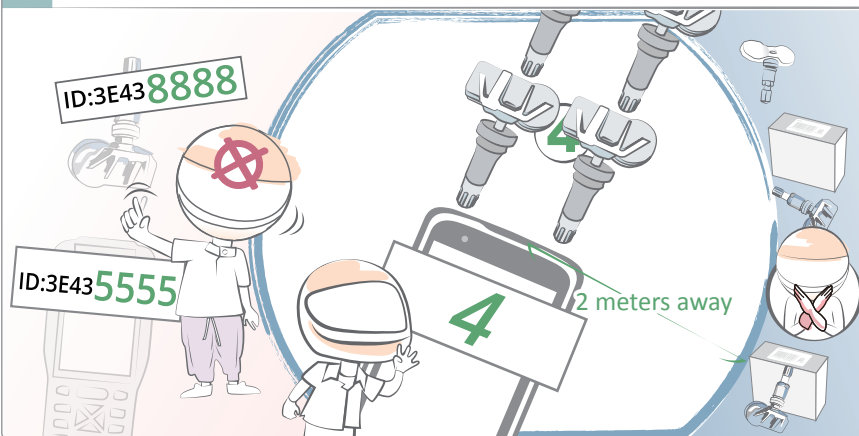

1. Please make sure the sensor ID and the programming sensors ID are the same.
2. Please follow the photo instruction on the left to place O-Genius and sensors. Be sure to keep other sensors at least 2 meters away.

5 Is it also possible to do the OBD transfer with “Retrieve ID”?

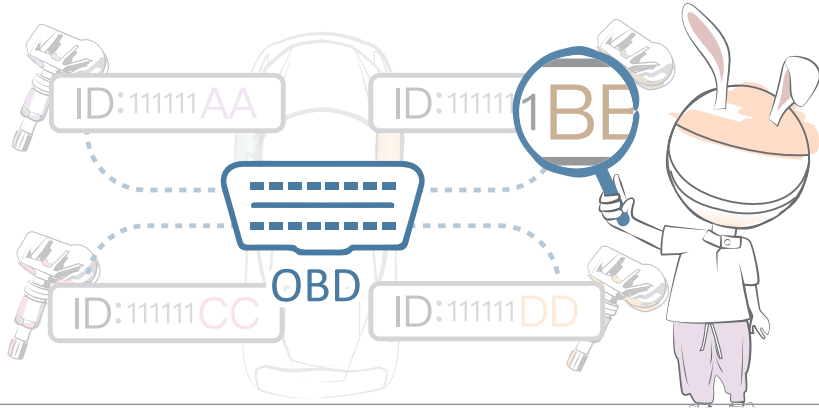

No, “Retrieve ID” only reads the sensor ID number from ECU. If sensor ID number need to be modify from ECU, please use OBD relearn procedure.

6 What is the functionality of “Retrieve ID”?

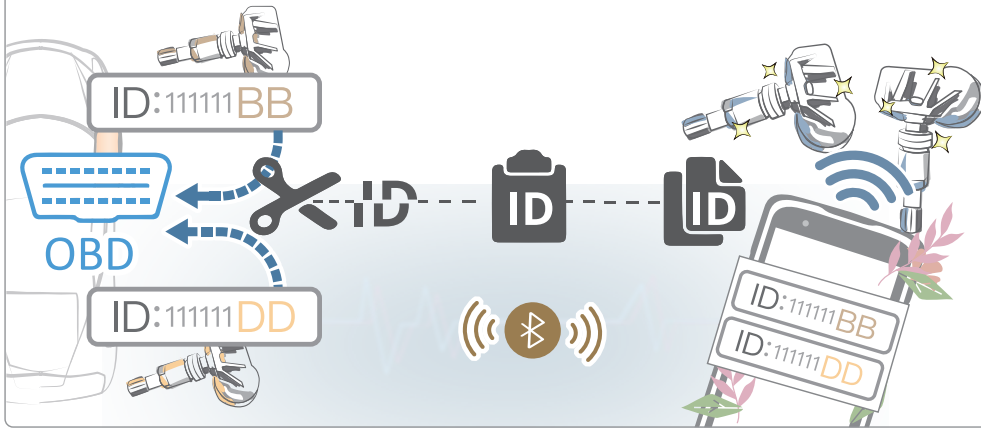

Using OBD to read the sensor ID number from ECU and copy the ID number to Orange sensor.

7 (OBD Relearn/ Retrieve ID) OBD bluetooth disconnected.



1. Restart the OBD Bluetooth.  
2. Keep the distance within 1 meter between O-Genius and OBD.

8 During OBD Relearn, do I need to connect to a cable or is it wireless connection?

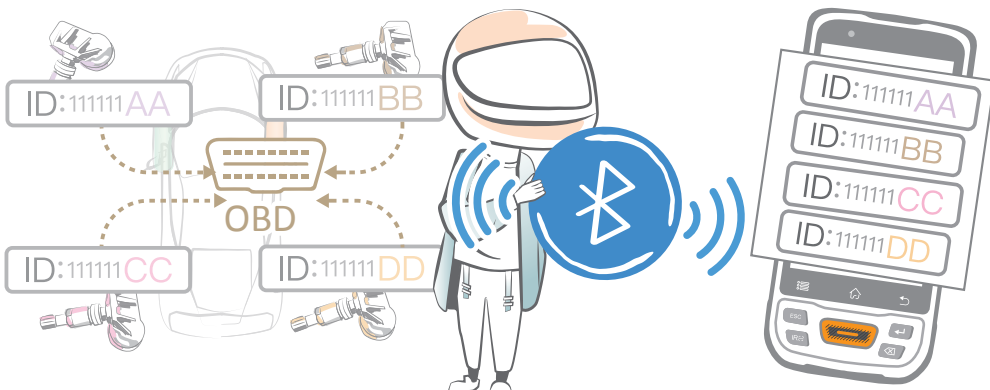

During OBD Relearn, it uses Bluetooth connection.

9 During OBD Relearn, does it only transfer sensor ID to ECU?

Yes, during OBD Relearn, you could only upload sensor ID to ECU.

\*Sensor ID and Tire position data are transferred to OBD separately.

10 How frequent should I update O-Genius?

It will inform you automatically, if there is an update.

11 Can it be updated through WiFi?

Yes, you could update through WiFi. Make sure O-Genius is plug-in to the power supply.

12 How to update O-Genius?

Please connect the tool to WiFi, and it will update automatically. Or you may go to the "setting", and choose "update", and doing the update manually.

**13** Can O-Genius be used without WiFi?

Yes, but it is recommended to connect O-Genius to Wi-Fi periodically, to make sure system is up to date.